



July 26, 2023

589 Avenue D, Suite 10
PO Box 787
Williston, VT 05495

www.kas-consulting.com

802.383.0486 p

802.383.0490 f

Ms. Sandy Gregg
Town of South Hero
P.O. Box 175
South Hero, VT 05486

RE: Lead Based Paint Inspection – Old White Meeting House, 320 US-2, South Hero, VT

Dear Ms. Gregg:

KAS, Inc. (KAS) is pleased to present the attached report which outlines the results of the lead-based paint inspection conducted at 320 US-2, South Hero, VT on July 6, 2023.

In summary, lead in amounts equal to or greater than 1.0 mg/cm² was found in paint at various locations on the interior and exterior of the building.

Thank you for this opportunity to be of service. Please call me should you have questions.

Sincerely,

Jeremy Roberts, P.G.
Principal / Environmental Program Manager

Enc/ cc: KAS #307230415



13 July 2023

Mr. Jeremy Roberts
KAS Consulting
589 Avenue D, Suite 10
PO Box 787
Williston, Vermont 05495

Re: Lead Assessment – So. Hero Meeting House, 320 Route 2, So. Hero, Vermont
K-D Project No. 05020-024

Dear Mr. Roberts:

At your request a representative of K-D Associates, Inc. visited the So. Hero Meeting House at 320 Route 2 in So. Hero, Vermont to conduct an inspection for the presence of lead-based paint (LBP) on the interior and exterior surfaces of the building. The screening was conducted to assess representative painted materials for the presence, quantity, locations, and character of LBP exterior surfaces. All work was conducted by a State of Vermont certified Lead Inspector.

Surfaces were classified by building component and substrate. Testing was specific and in sufficient detail to determine if individual surfaces tested do or do not contain LBP. All paint sampling was done by XRF testing. No results in the inconclusive range were recorded and no paint chip sampling or laboratory analysis was needed. The survey was conducted using a Niton XLp 300 model (Serial No. 7709) in the Lead-In-Paint K & L variable time reading mode. According to the instruments *Performance Characteristic Sheet*, the inconclusive range for this model is 0.8 to 1.2 mg/cm². Substrate correction is also not needed for this model on brick, concrete, drywall, plaster and wood. The objective of the testing was to find LBP surfaces with the concentration of lead above 1.0 mg/cm² by XRF analysis. Test location is identified by the side of the house with A being the front (roadside) and continuing B, C, D clockwise around the house.

The results of this inspection indicate that lead in amounts greater than or equal to 1.0 mg/cm² in paint was found on the following surfaces:

- Original wood (tan) and plaster (green) walls in rear portion of Room 1 (first floor meeting hall).
- Wood door (brown) in rear portion of Room 1 (first floor meeting hall).
- Yellow stripe on cement floor in Room 2 (front portion of meeting hall).
- Various wood window and window trim components (tan) in all interior spaces.
- Various wood door and door components throughout the interior.
- Wood stair components (grey) in the original stairway from the Entry Hall.
- Exterior wood (white) clapboard.
- Exterior wood (white) window and door trim.
- Exterior wood corner boards (white) and bottom boards (white).

Keep in mind that testing was of representative surfaces in each of the rooms and there may be exceptions to the findings for individual surfaces. Field data sheets showing results for individual surfaces tested are attached.

Please do not hesitate to call if you have any questions or need additional information.

Sincerely,

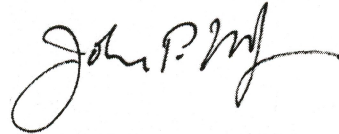
A handwritten signature in black ink, appearing to read "John P. Madigan". The signature is fluid and cursive, with a long horizontal stroke extending to the right.

John P. Madigan



LEAD - BASED PAINT FIELD SHEET

Date Sampled: 7/6/23

Inspector: John P. Madigan

Lead Inspector No: IT436397

XRF Serial No: 26588

Page: 1 of 9

Client: KAS Consulting
Address: So. Hero Meeting House, 320 Route 2, So. Hero, Vermont
KDAI Proj. No.: 05020-024

ROOM: 1 Meeting Hall (Rear) FLOOR: 1

Component	Test		Color	Condition	XRF Result (mg/cm2)	Correction Value	Corrected Reading	Classification
	Location	Substrate						
Wall	A	W	Unpainted			N/A	N/A	
Wall	B	W/P	T/GN	F	6.4/10.8	N/A	N/A	Pos
Wall	C	W/P	T/GN	F	17.1/3.0	N/A	N/A	Pos
Wall	D	W	Unpainted			N/A	N/A	
Ceiling	Not accessible	Tin				N/A	N/A	Assumed
Crown Molding						N/A	N/A	
Baseboard/Trim						N/A	N/A	
Chair Rail						N/A	N/A	
Floor						N/A	N/A	
Radiator						N/A	N/A	
Radiator Cover						N/A	N/A	
Shelves						N/A	N/A	
Cabinet						N/A	N/A	
Door 1	A	W	BR	F	2.0	N/A	N/A	Pos
						N/A	N/A	
		W	W	F	0.0	N/A	N/A	Neg
						N/A	N/A	
						N/A	N/A	
Window 1	C	W	T	F	19.5	N/A	N/A	Pos
						N/A	N/A	
		W	T	F	8.5	N/A	N/A	Pos
						N/A	N/A	
		W	T	F	8.1	N/A	N/A	Pos
				N/A	N/A			
Stairs		W	T	F	3.1	N/A	N/A	Pos
						N/A	N/A	
						N/A	N/A	
						N/A	N/A	
						N/A	N/A	
						N/A	N/A	
						N/A	N/A	

CALIBRATION	Standard 1.04
1ST READING	
2ND READING	
3RD READING	
CONDITION	
G = GOOD (No Visible Damage)	
F= FAIR (Less Than 10% Damage)	
P = POOR (Greater than 10% Damage)	

SUBSTRATE			
B=Brick	BL= Block	C=Concrete	GB=Gypsum Board
M = Metal	P=Plaster	V=Vinyl	W = Wood Other=

COLOR				
B=Beige	BL=Blue	BR=Brown	C=Cream	GR=Grey
GN=Green	PR=Purple	PK=Pink	R=Red	T=Tan
Y=Yellow	W = White	WP= Wall Paper	Other=	



LEAD - BASED PAINT FIELD SHEET

Date Sampled: 7/6/23

Inspector: John P. Madigan

Lead Inspector No: IT436397

XRF Serial No: 26588

Page: 2 of 9

Client: KAS Consulting
Address: So. Hero Meeting House, 320 Route 2, So. Hero, Vermont
KDAI Proj. No.: 05020-024

ROOM: 2 Meeting Hall (Front) FLOOR: 1

Component	Test		Color	Condition	XRF Result (mg/cm2)	Correction Value	Corrected Reading	Classification
	Location	Substrate						
Wall	A	W	Unpainted			N/A	N/A	
Wall	B	W	Unpainted			N/A	N/A	
Wall	C	W	Unpainted			N/A	N/A	
Wall	D	W	Unpainted			N/A	N/A	
Ceiling			Unpainted			N/A	N/A	
Crown Molding						N/A	N/A	
Baseboard/Trim						N/A	N/A	
Chair Rail						N/A	N/A	
Floor	Yellow stripe	Cement	Y	F	2.3	N/A	N/A	Pos
Radiator						N/A	N/A	
Radiator Cover						N/A	N/A	
Shelves						N/A	N/A	
Cabinet						N/A	N/A	
Door 1	A	W	Y	F	14.0	N/A	N/A	Pos
						N/A	N/A	
		W	Y	F	13.4	N/A	N/A	Pos
						N/A	N/A	
						N/A	N/A	
Window 1	B					N/A	N/A	
						N/A	N/A	
		W	W	F	6.9	N/A	N/A	Pos
						N/A	N/A	
		W	W	F	5.6	N/A	N/A	Pos
Stairs						N/A	N/A	
						N/A	N/A	
						N/A	N/A	
						N/A	N/A	
						N/A	N/A	
						N/A	N/A	

CALIBRATION	Standard 1.04
1ST READING	
2ND READING	
3RD READING	
CONDITION	
G = GOOD (No Visible Damage)	
F = FAIR (Less Than 10% Damage)	
P = POOR (Greater than 10% Damage)	

SUBSTRATE				
B=Brick	BL= Block	C=Concrete	GB=Gypsum Board	
M = Metal	P=Plaster	V=Vinyl	W = Wood	Other=

COLOR				
B=Beige	BL=Blue	BR=Brown	C=Cream	GR=Grey
GN=Green	PR=Purple	PK=Pink	R=Red	T=Tan
Y=Yellow	W = White	WP= Wall Paper	Other=	



LEAD - BASED PAINT FIELD SHEET

Date Sampled: 7/6/23
 Inspector: John P. Madigan
 Lead Inspector No: IT436397
 XRF Serial No: 26588
 Page: 3 of 9

Client: KAS Consulting
 Address: So. Hero Meeting House, 320 Route 2, So. Hero, Vermont
 KDAI Proj. No.: 05020-024

ROOM: 3 Entry Hall FLOOR: 1

Component	Test				XRF Result (mg/cm2)	Correction Value	Corrected Reading	Classification
	Location	Substrate	Color	Condition				
Wall	A	W	GN	G	0.7	N/A	N/A	Neg
Wall	B	W	GN	G	0.0	N/A	N/A	Neg
Wall	C	W	GN	G	0.0	N/A	N/A	Neg
Wall	D	W	GN	G	0.0	N/A	N/A	Neg
Ceiling		W	W	G	0.0	N/A	N/A	Neg
Crown Molding						N/A	N/A	
Baseboard/Trim	A	W	GN	G	8.4	N/A	N/A	Pos
Chair Rail						N/A	N/A	
Floor		W	GR	F	0.14	N/A	N/A	Neg
Column trim	A	W	GN	G	15.5	N/A	N/A	Pos
Radiator Cover						N/A	N/A	
Shelves						N/A	N/A	
Cabinet						N/A	N/A	
Door 1								
Door	A	W	GN	F	0.0	N/A	N/A	Neg
Casing		W	GN	F	0.0	N/A	N/A	Neg
Jamb		W	GN	F	0.0	N/A	N/A	Neg
Stop						N/A	N/A	
Threshold						N/A	N/A	
Window 1								
Casing/Apron	A	W	GN	F	6.4	N/A	N/A	Pos
Stop						N/A	N/A	
Jamb		W	GN	F	8.5	N/A	N/A	Pos
Window Well						N/A	N/A	
Sill		W	GN	F	2.0	N/A	N/A	Pos
Sash/Mullion		W	GN	F	14.0	N/A	N/A	Pos
Stairs								
Stair Tread	Original	W	GR	F	2.5	N/A	N/A	Pos
Stair Riser		W	GR	F	6.0	N/A	N/A	Pos
Stair Stringer		W	GN	F	7.5	N/A	N/A	Pos
Newel Post		W	GR	F	1.4	N/A	N/A	Pos
Baluster		W	GN	F	1.5	N/A	N/A	Pos
Hand Rail		W	GR	F	1.9	N/A	N/A	Pos

CALIBRATION	Standard 1.04
1ST READING	
2ND READING	
3RD READING	
CONDITION	
G = GOOD (No Visible Damage)	
F = FAIR (Less Than 10% Damage)	
P = POOR (Greater than 10% Damage)	

SUBSTRATE				
B=Brick	BL= Block	C=Concrete	GB=Gypsum Board	
M = Metal	P=Plaster	V=Vinyl	W = Wood	Other=

COLOR				
B=Beige	BL=Blue	BR=Brown	C=Cream	GR=Grey
GN=Green	PR=Purple	PK=Pink	R=Red	T=Tan
Y=Yellow	W = White	WP= Wall Paper	Other=	



LEAD - BASED PAINT FIELD SHEET

Date Sampled: 7/6/23

Inspector: John P. Madigan

Lead Inspector No: IT436397

XRF Serial No: 26588

Page: 4 of 9

Client: KAS Consulting
Address: So. Hero Meeting House, 320 Route 2, So. Hero, Vermont
KDAI Proj. No.: 05020-024

ROOM: 4 FLOOR: 2

Component	Test				XRF Result (mg/cm2)	Correction Value	Corrected Reading	Classification	
	Location	Substrate	Color	Condition					
Wall	A	W	GN	G	1.6	N/A	N/A	Pos	
Wall	B	W	GN	G	1.9	N/A	N/A	Pos	
Wall	C	W	GN	G	1.4	N/A	N/A	Pos	
Wall	D	W	GN	G	1.8	N/A	N/A	Pos	
Ceiling		W	W	G	0.0	N/A	N/A	Neg	
Crown Molding						N/A	N/A		
Baseboard/Trim						N/A	N/A		
Chair Rail						N/A	N/A		
Floor		W	GR	F	0.3	N/A	N/A	Neg	
Column trim	A	W	GN	G	6.4	N/A	N/A	Pos	
Radiator Cover						N/A	N/A		
Shelves						N/A	N/A		
Cabinet						N/A	N/A		
Door 1	A	W	GN	F	3.6	N/A	N/A	Pos	
		W	GN	F	14.4	N/A	N/A	Pos	
		W	GN	F	4.4	N/A	N/A	Pos	
							N/A	N/A	
							N/A	N/A	
Window 1	B	W	GN	F	5.2	N/A	N/A	Pos	
							N/A	N/A	
		W	GN	F	6.1	N/A	N/A	Pos	
							N/A	N/A	
		W	GN	F	4.9	N/A	N/A	Pos	
					N/A	N/A			
Stairs						N/A	N/A		
						N/A	N/A		
						N/A	N/A		
						N/A	N/A		
						N/A	N/A		
						N/A	N/A		
						N/A	N/A		

CALIBRATION	Standard 1.04
1ST READING	
2ND READING	
3RD READING	
CONDITION	
G = GOOD (No Visible Damage)	
F = FAIR (Less Than 10% Damage)	
P = POOR (Greater than 10% Damage)	

SUBSTRATE				
B=Brick	BL= Block	C=Concrete	GB=Gypsum Board	
M = Metal	P=Plaster	V=Vinyl	W = Wood	Other=

COLOR				
B=Beige	BL=Blue	BR=Brown	C=Cream	GR=Grey
GN=Green	PR=Purple	PK=Pink	R=Red	T=Tan
Y=Yellow	W = White	WP= Wall Paper	Other=	



LEAD - BASED PAINT FIELD SHEET

Date Sampled: 7/6/23

Inspector: John P. Madigan

Lead Inspector No: IT436397

XRF Serial No: 26588

Page: 5 of 9

Client: KAS Consulting
Address: So. Hero Meeting House, 320 Route 2, So. Hero, Vermont
KDAI Proj. No.: 05020-024

ROOM: 5 FLOOR: 2

Component	Test		Color	Condition	XRF Result (mg/cm2)	Correction Value	Corrected Reading	Classification	
	Location	Substrate							
Wall	A	W	GN	G	2.5	N/A	N/A	Pos	
Wall	B	W	GN	G	2.0	N/A	N/A	Pos	
Wall	C	W	GN	G	1.9	N/A	N/A	Pos	
Wall	D	W	GN	G	2.3	N/A	N/A	Pos	
Ceiling		W	W	G	0.0	N/A	N/A	Neg	
Crown Molding						N/A	N/A		
Baseboard/Trim						N/A	N/A		
Chair Rail						N/A	N/A		
Floor		W	GR	F	2.7	N/A	N/A	Pos	
Column trim	A	W	GN	G	8.4	N/A	N/A	Pos	
Radiator Cover						N/A	N/A		
Shelves						N/A	N/A		
Cabinet						N/A	N/A		
Door 1	Door	B				N/A	N/A		
	Casing		W	GN	F	3.3	N/A	N/A	Pos
	Jamb		W	GN	F	21.9	N/A	N/A	Pos
	Stop						N/A	N/A	
	Threshold		W	GR	F	0.0	N/A	N/A	Neg
Window 1	Casing/Apron	D	W	GN	F	4.8	N/A	N/A	Pos
	Stop						N/A	N/A	
	Jamb		W	GN	F	6.0	N/A	N/A	Pos
	Window Well						N/A	N/A	
	Sill		W	W	F	5.2	N/A	N/A	Pos
Sash/Mullion		W	GN	F	4.1	N/A	N/A	Pos	
Stairs	Stair Tread						N/A	N/A	
	Stair Riser						N/A	N/A	
	Stair Stringer						N/A	N/A	
	Newel Post						N/A	N/A	
	Baluster						N/A	N/A	
	Hand Rail						N/A	N/A	

CALIBRATION	Standard 1.04
1ST READING	
2ND READING	
3RD READING	
CONDITION	
G = GOOD (No Visible Damage)	
F = FAIR (Less Than 10% Damage)	
P = POOR (Greater than 10% Damage)	

SUBSTRATE				
B=Brick	BL= Block	C=Concrete	GB=Gypsum Board	
M = Metal	P=Plaster	V=Vinyl	W = Wood	Other=

COLOR				
B=Beige	BL=Blue	BR=Brown	C=Cream	GR=Grey
GN=Green	PR=Purple	PK=Pink	R=Red	T=Tan
Y=Yellow	W = White	WP= Wall Paper	Other=	



LEAD - BASED PAINT FIELD SHEET

Date Sampled: 7/6/23

Inspector: John P. Madigan

Lead Inspector No: IT436397

XRF Serial No: 26588

Page: 6 of 9

Client: KAS Consulting
Address: So. Hero Meeting House, 320 Route 2, So. Hero, Vermont
KDAI Proj. No.: 05020-024

ROOM: 6 Storage FLOOR: 2

Component	Test		Color	Condition	XRF Result (mg/cm2)	Correction Value	Corrected Reading	Classification	
	Location	Substrate							
Wall	A	W	GN	G	2.0	N/A	N/A	Pos	
Wall	B	W	GN	G	3.1	N/A	N/A	Pos	
Wall	C	W	GN	G	2.4	N/A	N/A	Pos	
Wall	D	W	GN	G	2.1	N/A	N/A	Pos	
Ceiling		W	W	G	2.0	N/A	N/A	Pos	
Crown Molding						N/A	N/A		
Baseboard/Trim						N/A	N/A		
Chair Rail						N/A	N/A		
Floor		W	GR	F	0.5	N/A	N/A	Neg	
Column trim						N/A	N/A		
Radiator Cover						N/A	N/A		
Shelves						N/A	N/A		
Cabinet						N/A	N/A		
Door 1	Door	C	W	GN	F	7.1	N/A	N/A	Pos
	Casing		W	GN	F	17.0	N/A	N/A	Pos
	Jamb		W	GN	F	13.5	N/A	N/A	Pos
	Stop						N/A	N/A	
	Threshold		W	GR	F	13.5	N/A	N/A	Pos
Window 1	Casing/Apron	A	W	GN	F	5.7	N/A	N/A	Pos
	Stop						N/A	N/A	
	Jamb						N/A	N/A	
	Window Well						N/A	N/A	
	Sill		W	GN	F	4.8	N/A	N/A	Pos
	Sash/Mullion		W	GN	F	5.2	N/A	N/A	Pos
Stairs	Stair Tread						N/A	N/A	
	Stair Riser						N/A	N/A	
	Stair Stringer						N/A	N/A	
	Newel Post						N/A	N/A	
	Baluster						N/A	N/A	
	Hand Rail						N/A	N/A	

CALIBRATION	Standard 1.04
1ST READING	
2ND READING	
3RD READING	
CONDITION	
G = GOOD (No Visible Damage)	
F = FAIR (Less Than 10% Damage)	
P = POOR (Greater than 10% Damage)	

SUBSTRATE				
B=Brick	BL= Block	C=Concrete	GB=Gypsum Board	
M = Metal	P=Plaster	V=Vinyl	W = Wood	Other=

COLOR				
B=Beige	BL=Blue	BR=Brown	C=Cream	GR=Grey
GN=Green	PR=Purple	PK=Pink	R=Red	T=Tan
Y=Yellow	W = White	WP= Wall Paper	Other=	



LEAD - BASED PAINT FIELD SHEET

Date Sampled: 7/6/23

Inspector: John P. Madigan

Lead Inspector No: IT436397

XRF Serial No: 26588

Page: 7 of 9

Client: KAS Consulting
Address: So. Hero Meeting House, 320 Route 2, So. Hero, Vermont
KDAI Proj. No.: 05020-024

ROOM: 7 Storage FLOOR: 2

Component	Test				XRF Result (mg/cm ²)	Correction Value	Corrected Reading	Classification	
	Location	Substrate	Color	Condition					
Wall	A	W	B	G	6.1	N/A	N/A	Pos	
Wall	B	W	B	G	5.9	N/A	N/A	Pos	
Wall	C	W	B	G	5.8	N/A	N/A	Pos	
Wall	D	W	B	G	6.2	N/A	N/A	Pos	
Ceiling						N/A	N/A		
Crown Molding						N/A	N/A		
Baseboard/Trim						N/A	N/A		
Chair Rail						N/A	N/A		
Floor		W	GR	F	0.5	N/A	N/A	Neg	
Column trim						N/A	N/A		
Radiator Cover						N/A	N/A		
Shelves						N/A	N/A		
Cabinet						N/A	N/A		
Door 1	Door	D	W	B	F	4.5	N/A	N/A	Pos
	Casing		W	B	F	6.6	N/A	N/A	Pos
	Jamb		W	B	F	6.2	N/A	N/A	Pos
	Stop						N/A	N/A	
	Threshold						N/A	N/A	
Window 1	Casing/Apron						N/A	N/A	
	Stop						N/A	N/A	
	Jamb						N/A	N/A	
	Window Well						N/A	N/A	
	Sill						N/A	N/A	
	Sash/Mullion						N/A	N/A	
Stairs	Stair Tread						N/A	N/A	
	Stair Riser						N/A	N/A	
	Stair Stringer						N/A	N/A	
	Newel Post						N/A	N/A	
	Baluster						N/A	N/A	
	Hand Rail						N/A	N/A	

CALIBRATION	Standard 1.04
1ST READING	
2ND READING	
3RD READING	
CONDITION	
G = GOOD (No Visible Damage)	
F = FAIR (Less Than 10% Damage)	
P = POOR (Greater than 10% Damage)	

SUBSTRATE				
B=Brick	BL= Block	C=Concrete	GB=Gypsum Board	
M = Metal	P=Plaster	V=Vinyl	W = Wood	Other=

COLOR				
B=Beige	BL=Blue	BR=Brown	C=Cream	GR=Grey
GN=Green	PR=Purple	PK=Pink	R=Red	T=Tan
Y=Yellow	W = White	WP= Wall Paper	Other=	



LEAD - BASED PAINT FIELD SHEET

Date Sampled: 7/6/23

Inspector: John P. Madigan

Lead Inspector No: IT436397

XRF Serial No: 26588

Page: 8 of 9

Client: KAS Consulting
Address: So. Hero Meeting House, 320 Route 2, So. Hero, Vermont
KDAI Proj. No.: 05020-024

ROOM: 8 Stairway FLOOR: 1/2

Component	Test		Color	Condition	XRF Result (mg/cm2)	Correction Value	Corrected Reading	Classification	
	Location	Substrate							
Wall	A	W	B	F	5.7	N/A	N/A	Pos	
Wall	B	P	B	F	5.5	N/A	N/A	Pos	
Wall	C	P	B	F	6.8	N/A	N/A	Pos	
Wall	D	W	B	F	6.6	N/A	N/A	Pos	
Ceiling		Tin	W	P		N/A	N/A	Assumed	
Crown Molding						N/A	N/A		
Baseboard/Trim						N/A	N/A		
Chair Rail						N/A	N/A		
Floor						N/A	N/A		
Column trim						N/A	N/A		
Radiator Cover						N/A	N/A		
Shelves						N/A	N/A		
Cabinet						N/A	N/A		
Door 1	Door	C	W	B	F	6.5	N/A	N/A	Pos
	Casing		W	B	F	5.6	N/A	N/A	Pos
	Jamb		W	B	F	6.7	N/A	N/A	Pos
	Stop						N/A	N/A	
	Threshold						N/A	N/A	
Window 1	Casing/Apron	D	W	B	F	5.2	N/A	N/A	Pos
	Stop						N/A	N/A	
	Jamb		W	B	F	5.9	N/A	N/A	Pos
	Window Well						N/A	N/A	
	Sill		W	B	F	5.8	N/A	N/A	Pos
Sash/Mullion		W	B	F	6.1	N/A	N/A	Pos	
Stairs	Stair Tread						N/A	N/A	
	Stair Riser						N/A	N/A	
	Stair Stringer						N/A	N/A	
	Newel Post						N/A	N/A	
	Baluster						N/A	N/A	
	Hand Rail						N/A	N/A	

CALIBRATION	Standard 1.04
1ST READING	
2ND READING	
3RD READING	
CONDITION	
G = GOOD (No Visible Damage)	
F= FAIR (Less Than 10% Damage)	
P = POOR (Greater than 10% Damage)	

SUBSTRATE			
B=Brick	BL= Block	C=Concrete	GB=Gypsum Board
M = Metal	P=Plaster	V=Vinyl	W = Wood Other=

COLOR			
B=Beige	BL=Blue	BR=Brown	C=Cream GR=Grey
GN=Green	PR=Purple	PK=Pink	R=Red T=Tan
Y=Yellow	W = White	WP= Wall Paper	Other=

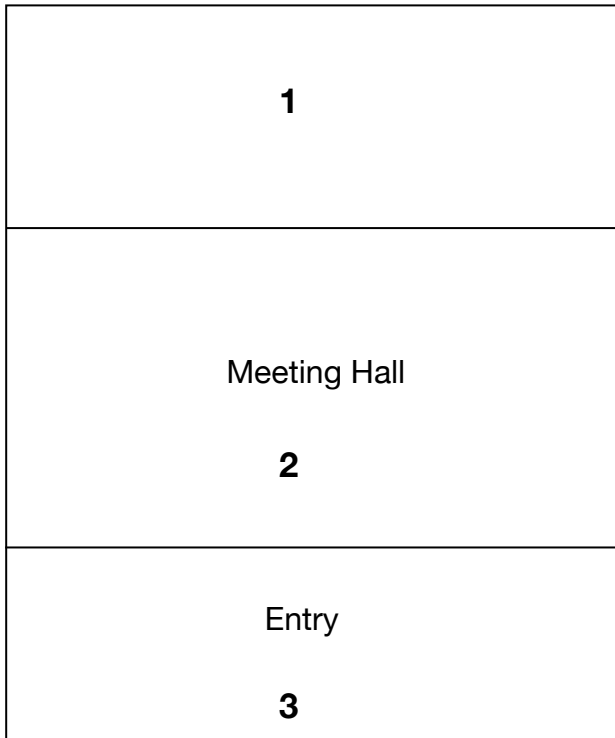

First Floor Plan

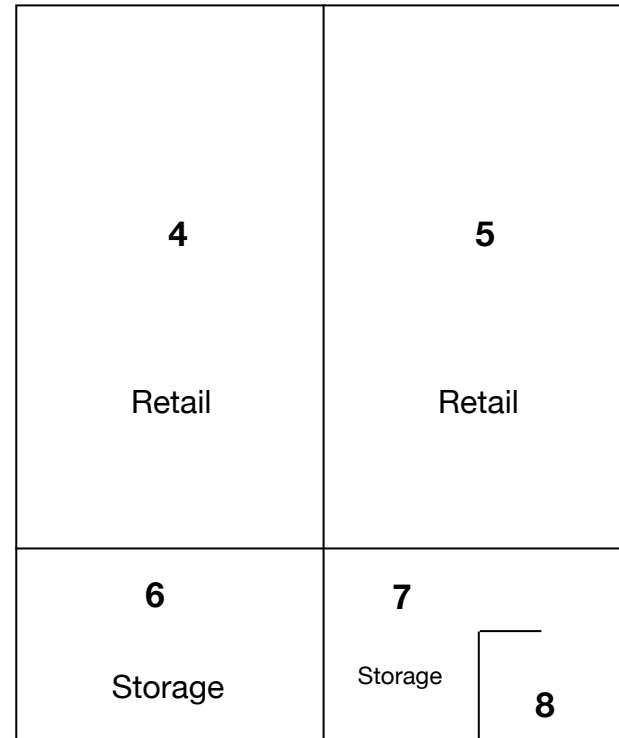

Second Floor Plan

South Hero Meeting Hall
320 Rte. 2
South Hero, VT 05486

K-D Associates, Inc.
05020-024